

DECK,
SILL SEALER, SHIMS
FOR BLOCKING,
INSULATION, ROOFING
& FACIA BY G.C.

FACIA MUST EXTEND
A MIN OF 2" BELOW
TOP OF PANEL

ENDLIFTER @ 2
PER PANEL
BY FABCON

EMBED @ X
PER PANEL
BY FABCON

VERSACORE
WALL PANEL

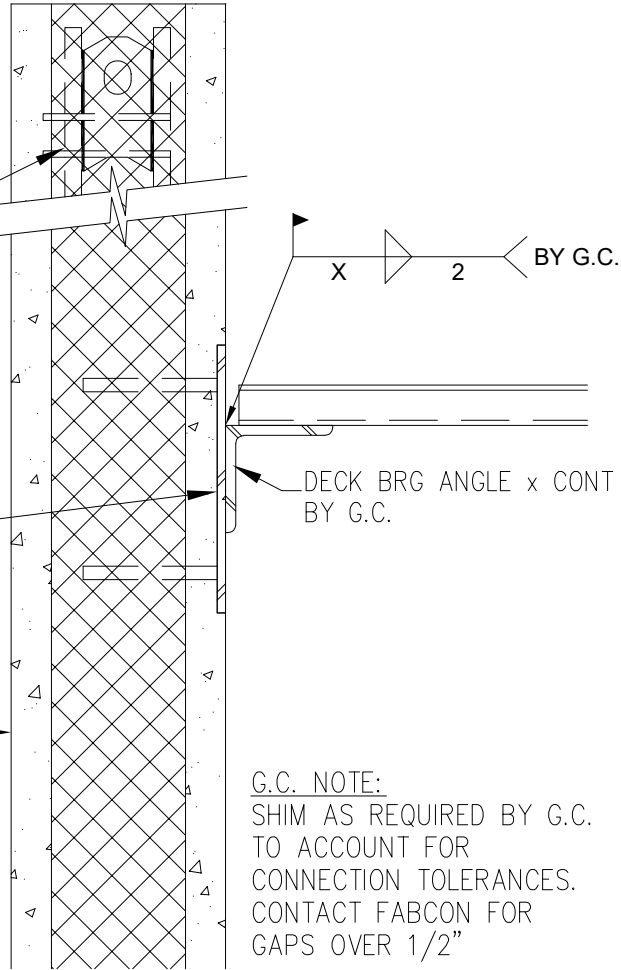

G.C. NOTE:
SHIM AS REQUIRED BY G.C.
TO ACCOUNT FOR
CONNECTION TOLERANCES.
CONTACT FABCON FOR
GAPS OVER 1/2"

DETAIL
1 1/2" = 1'-0"